

# SHOCKWAVE KARTING

## 2008 CHASSIS PREVIEW New Caster/Camber Adjustment System!

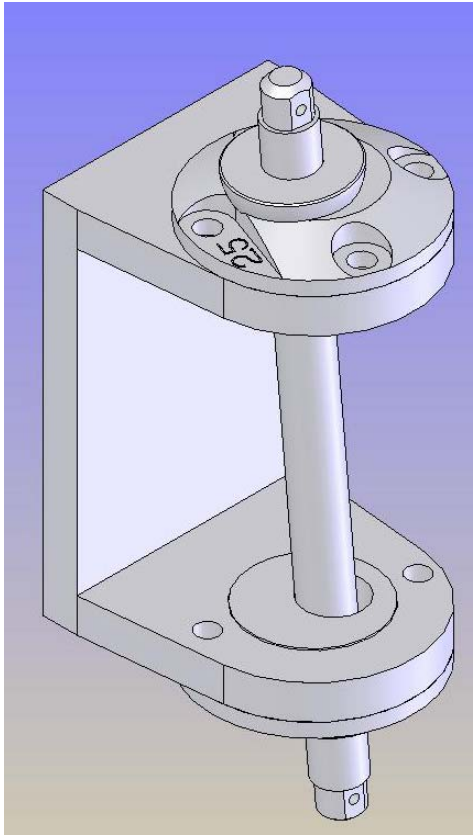

3D CAD model showing full 5° negative caster angle.

We're in the process of testing our new 2008 chassis, and we're pretty excited about the new models.

Of particular note is our new caster & camber adjustment system. For years, karts have used a single eccentric element to adjust the caster and camber. This makes it difficult or impossible to adjust caster and camber independently.

Our new chassis features two 4mm screws that hold the eccentric pill in place, ensuring that the pill is lined up perfectly in the desired axis. This allows you to adjust caster completely independently of camber. Additionally, there is no longer any need to readjust the toe-in/toe-out when adjusting caster, as the toe does not change unless there is a camber change.

The system uses a series of pills with different offsets to enable quick and easy caster/camber adjustments. Pills are available in 0.5° increments from 0 to 2.5° for precise chassis tuning. Pills can be used top and bottom, allowing for a total of ±5° caster or camber, or ±2.5° caster AND camber simultaneously. A typical setup would use one pill on top to adjust caster 2.5° positive or negative, and a second pill on the bottom to adjust camber 2.5° positive or negative. Simply put, this system gives the tuner incredible ability to precisely tune the chassis to the driver's needs and the track conditions. The king pin bolt has nuts on both top and bottom so that either pill can be changed without completely

dismantling the assembly.

On our 2008 chassis, adjusting caster is often easier and faster than moving the front track width! Imagine being able to change caster DURING a practice or qualifying session, and heading right back out on the track! And this system isn't just for the adults; *every* 2008

Shockwave chassis will feature this system, including cadets. See the following page for more photos.

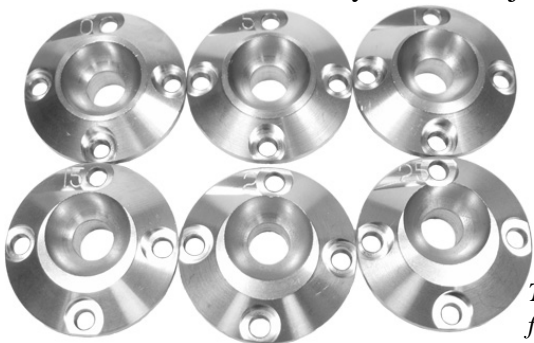

The full set of pills, from 0° to 2.5°.



A 2.5° pill, clearly showing the offset and easy-to-read 2.5 label.

